

# **about home**

Bespoke Collection

**about home**

The Masterpiece.

Craft your Dining Experience

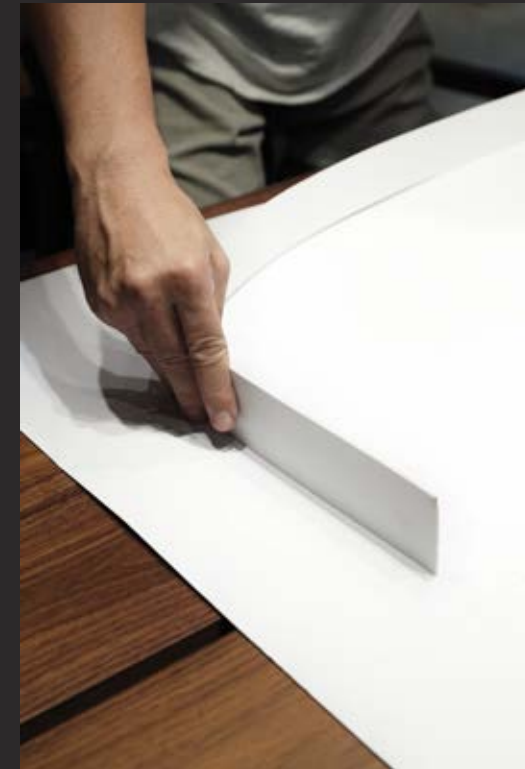

One-of-a-kind piece, our **Bespoke Collection** allows you to collaborate closely with us to bring your unique ideas to life.



Crafting bespoke furniture, from initial design sketches to material selection, the process is tailored to the client's specifications, resulting in a truly one-of-a-kind piece.



# Step 1

Choose your design

Original

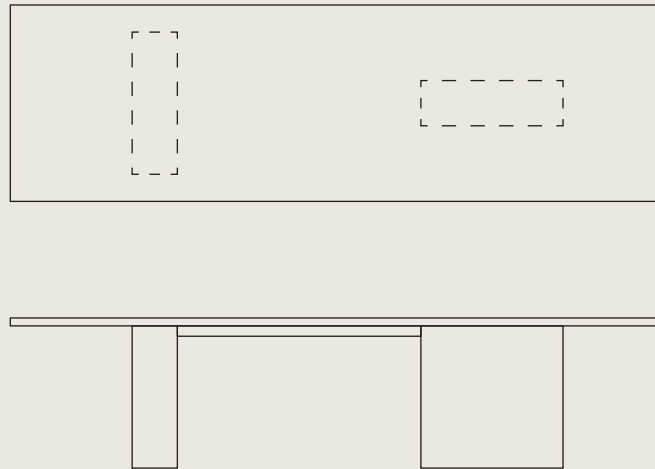

The “**Original Collection**” are deeply integrated with timeless sensation. Simple, functional, and minimal through the aesthetic of craftsmanship.

Phuphā

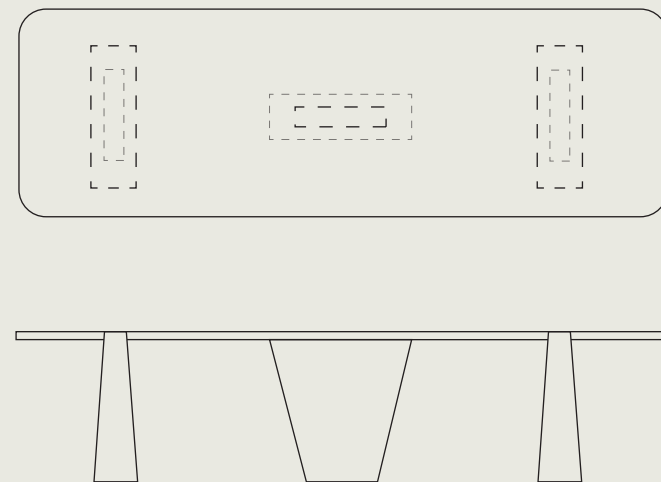

“**Phupha Collection**” seeks to translate the grandeur, strength, and distinct contours of mountains into a series of unique and artistic tables that seamlessly blend nature-inspired aesthetics with modern functionality.

Deeply integrated with timeless sensation.

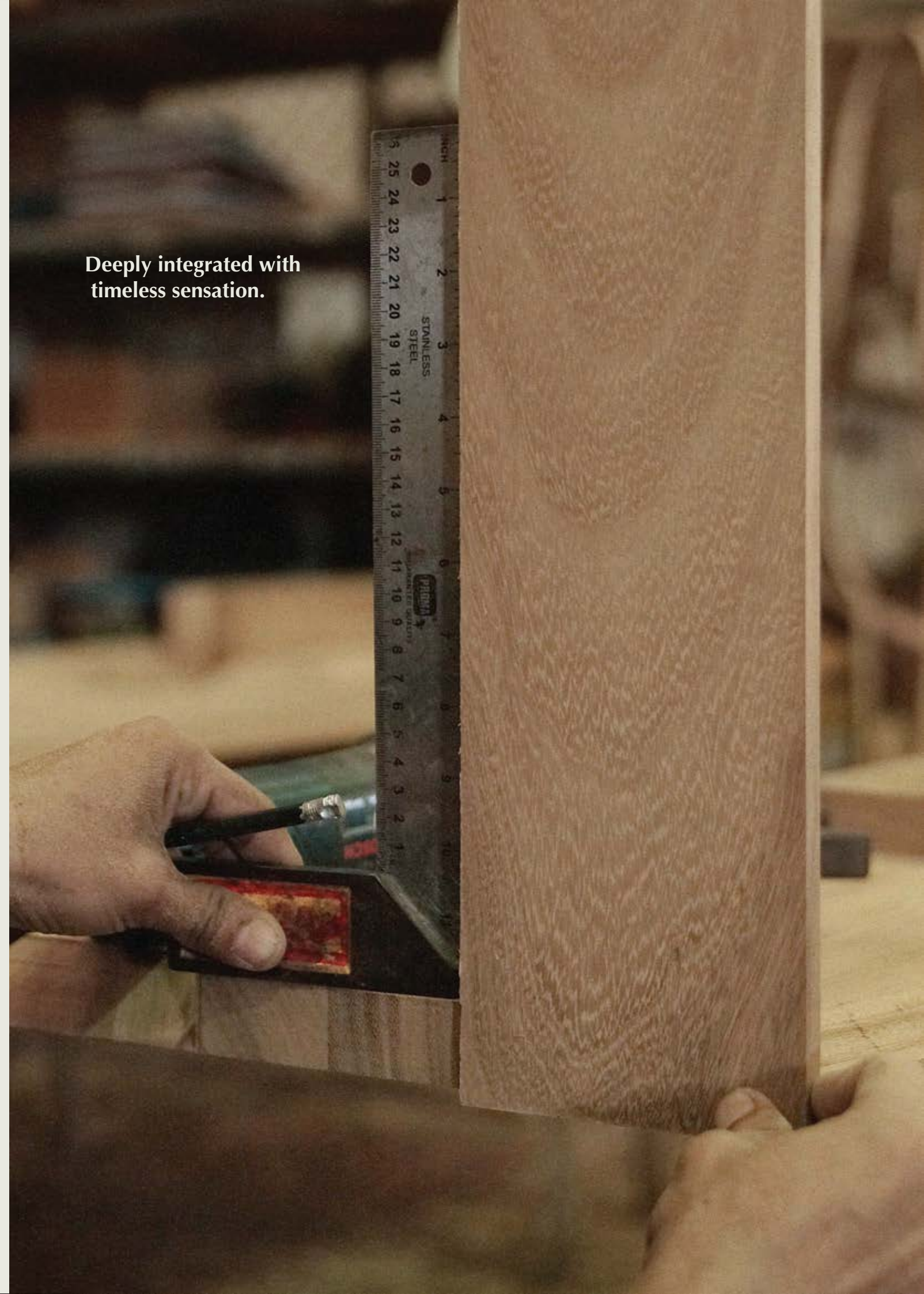

Choose your design

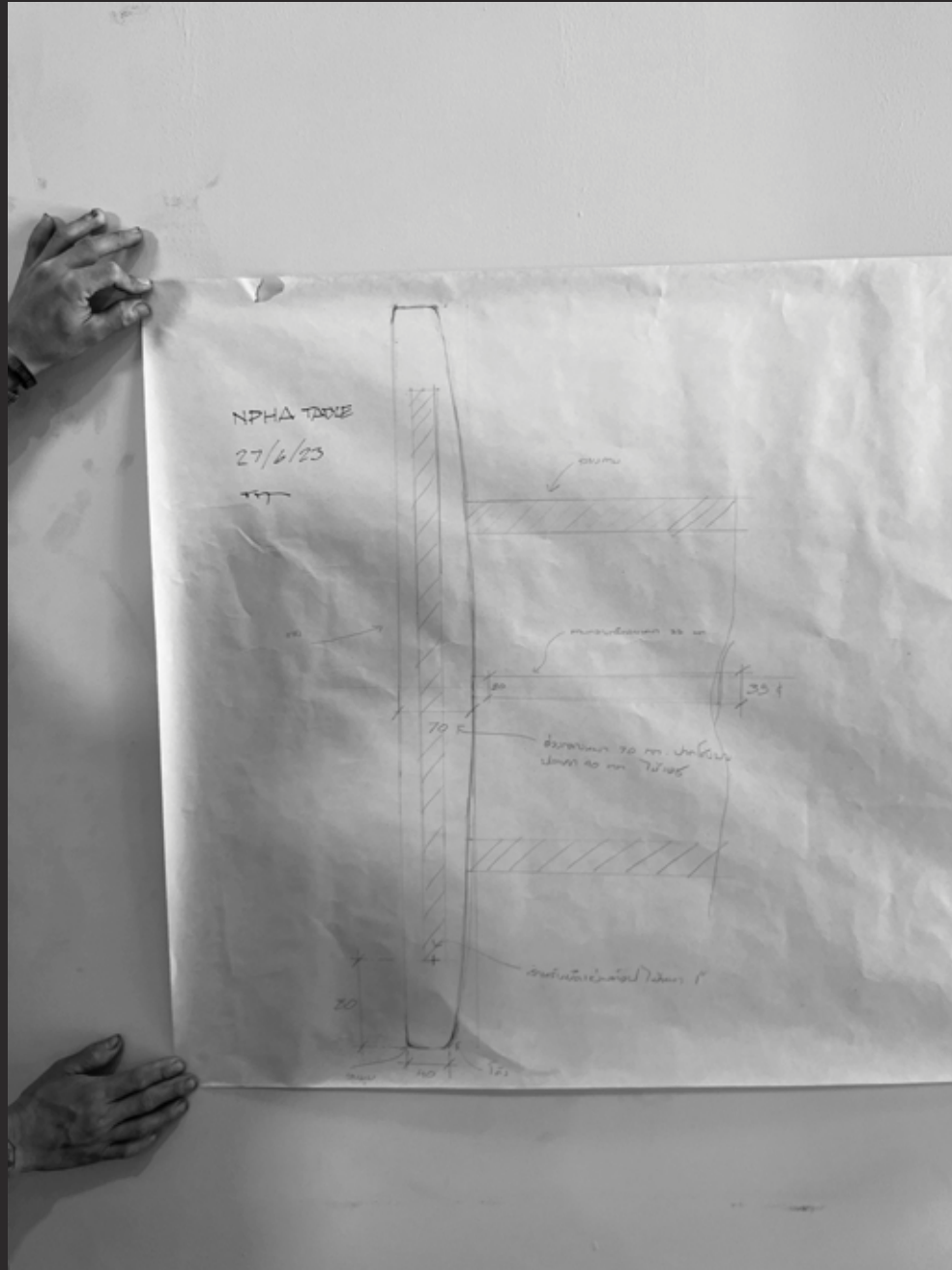

Nphā

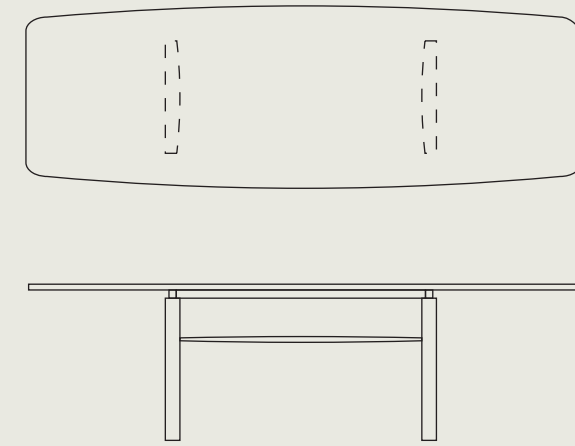

"Npha Collection" captures the very essence of nature's most captivating phenomena. A mesmerizing ensemble inspired by the ethereal movements of the sky.

Sāla  
(Seasonal)

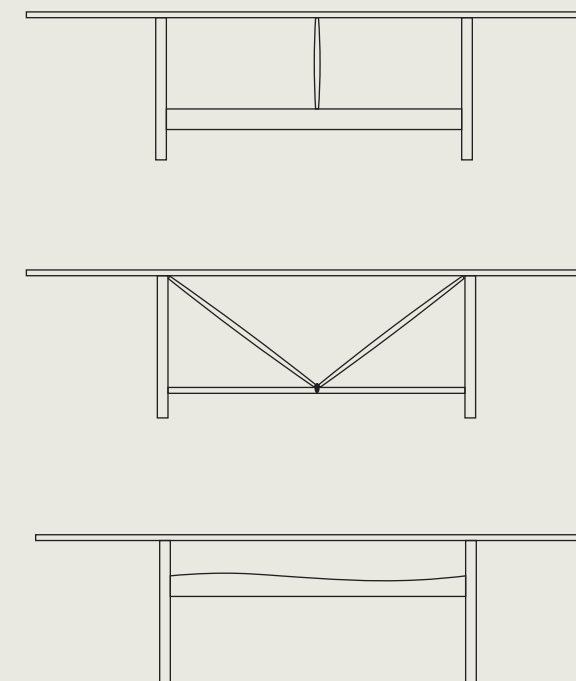

The "Sala Collection" is a table design concept that draws inspiration from the honest and straightforward structural elements of traditional Thai architectural pavilions, or "salas."



Choose your design

Klom

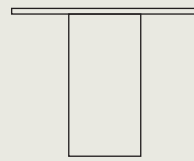
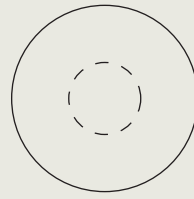

Plus +

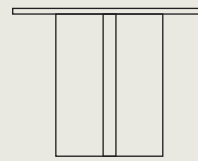
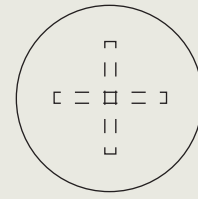

“**Klom Collection**” embraces the symbolism and functionality associated with circles while infusing modern aesthetics and functional versatility into a series of round tables.

Saarn



“**Saarn Collection**” is an innovative and eco-conscious table, designed from discarded woods. Showcasing the beauty of reclaimed materials while promoting environmental responsibility.







## Step 2

Table top

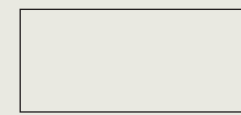

Rectangle



Round edge

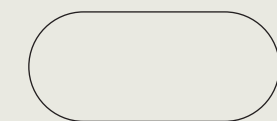

Oval



Round

## Step 3

Dimension

4 Seats

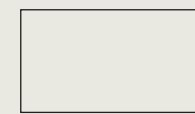

240

6-8 Seats

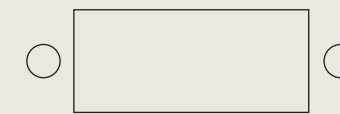

270-300

10-12 Seats



320-400

## Step 4

Edge

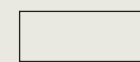

Square

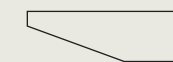

Slim



Round



Tapered

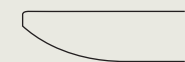

Curve

Our skilled artisans and craftsmen meticulously inspect and hand-select each piece of wood to ensure its quality and suitability for our products.

# Step 5

Choose your Pattern

Wood Layout Pattern

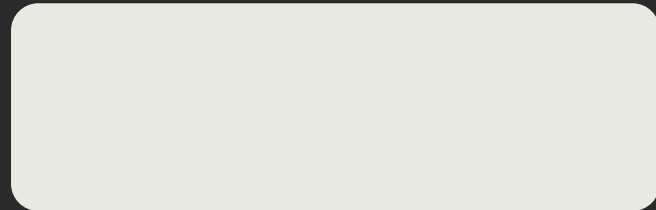

Standard

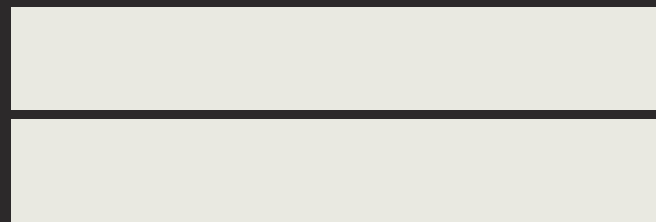

Duo

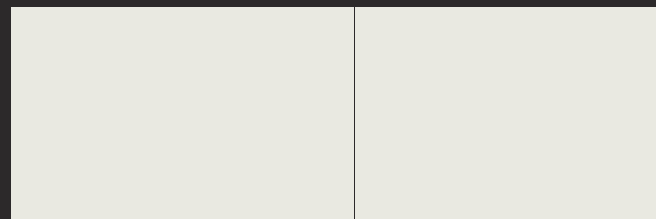

Join

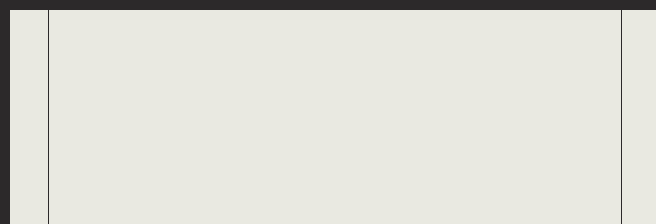

Edge Join

Wood Layout Pattern

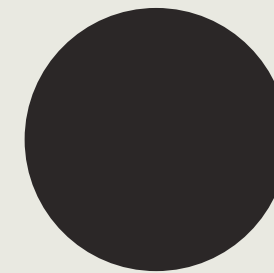

Standard

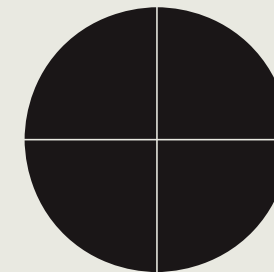

Radial

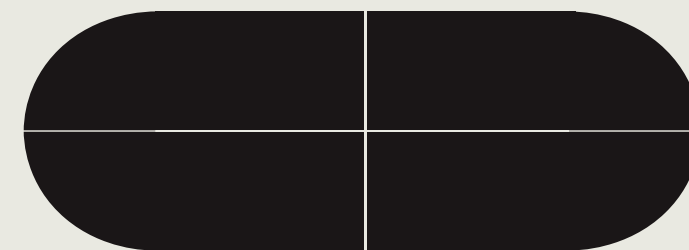

Capsule Radial

**"Npha Collection"** captures the very essence of nature's most captivating phenomena.  
A mesmerizing ensemble inspired by the ethereal movements of the sky.



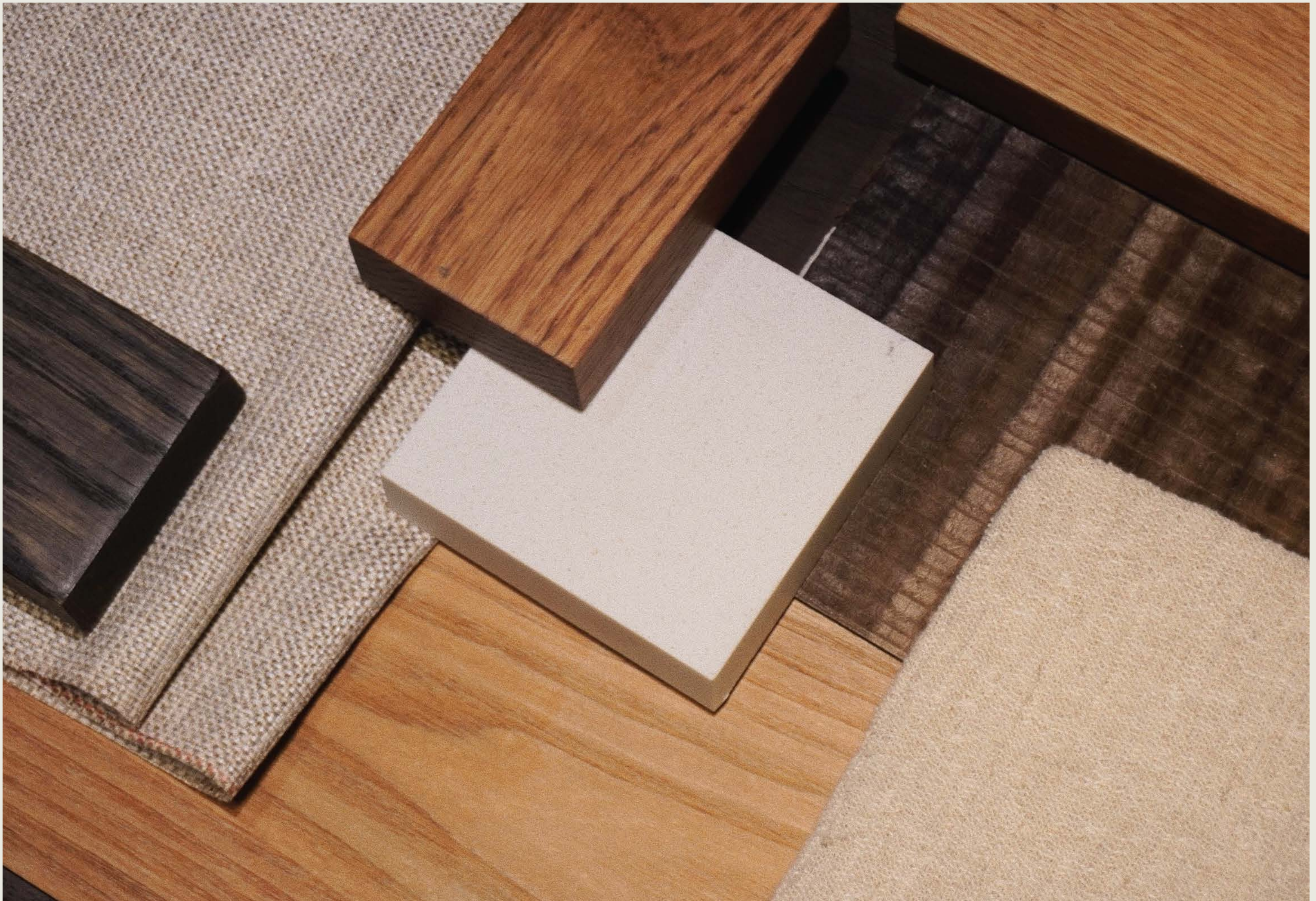





# Step 6

Choose your Material

## 01 / Table Top

Wood:



Oak



Walnut



Ash



Exclusive Seasonal

Stone:

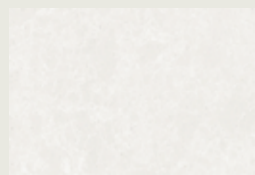

White

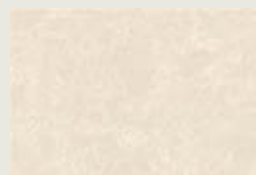

Beige



Black

## 02 / Frame & Structure



Oak



Ash

## 03 / Texture



Smooth Grain



Natural Grain

**Wood** is a living material, subject to natural variations that result in diverse patterns and grains. These variations are beyond our control, and we do not alter or manipulate the wood patterns to conform to specific designs. We embrace the organic beauty that arises from the natural processes that shape wood over time.

# Material Taxonomy

## 04 / Colour



Natural Oak

N-O



Natural White

N-W



Natural Black

N-W



Dark Oak

ADW-01



Dark Oak

ADW-02



Walnut Oak

W-O

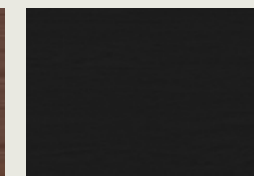

Black



Natural Ash

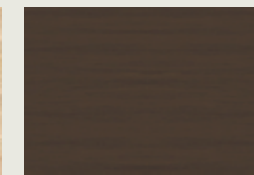

Chocolate Ash

C-A

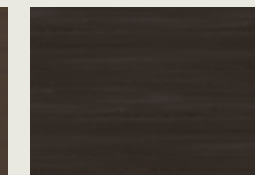

Smoked Ash

S-A



Grey Ash

S-A

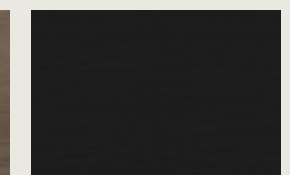

Black

## 05 / Finishing

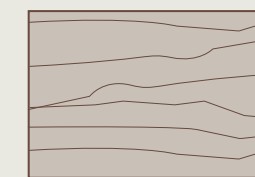

Water-based

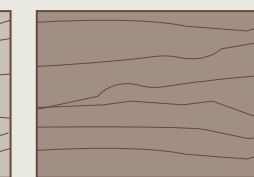

Oil

- **Water-based Solvent:** Resistance, and protection against water and chemicals with applied coating for great durability & clarity and ability to maintain the natural color of wood.

- **Oil-based Solvent:** Oil-based finishes tend to have a warmer and richer appearance, enhancing the natural color and grain of wood. They can deepen the color and create a more traditional look.









### **Design and Craftsmanship:**

**Regulatory Compliance:** Our designs respect regulations governing wood species, treatments, and finishes, ensuring legal adherence in every product.

**Artisanal Excellence:** We uphold the highest craftsmanship standards, combining traditional techniques with modern practices to create lasting and captivating products.

### **Sourcing and Sustainability:**

**Certification Standards:** All wood materials must adhere to recognized certifications, such as FSC or PEFC, ensuring responsible sourcing and environmentally conscious practices.

### **User Safety:**

**Stability and Durability:** Our products are designed to adhere to safety standards, emphasizing stability, weight capacity, and long-term durability.

**Finishing Materials:** We use finishes and coatings that meet safety and environmental regulations, maintaining indoor air quality standards.

### **Waste Management and Sustainability:**

**Waste Reduction:** We prioritize waste reduction through efficient material usage and proper disposal practices.

**Recycling Commitment:** Our products are designed to consider end-of-life scenarios, encouraging recycling and responsible waste management.

**about home**

Designed and Crafted in Thailand

[www.abouthomefurniture.com](http://www.abouthomefurniture.com)

